

# Welcome to the West Area Planning Committee

- This planning committee meeting is held in public but it is not a public meeting.
- There will be an opportunity for the public to address the committee on each application.
- If you wish to speak for or against a planning application, you need to have either requested it in advance, or hand in one of the available speaker forms, or speak to the clerk.
- Information on meeting protocol and conduct at the committee is set out in the Code of Practice.
- This is in the committee agenda just before the first planning application report.

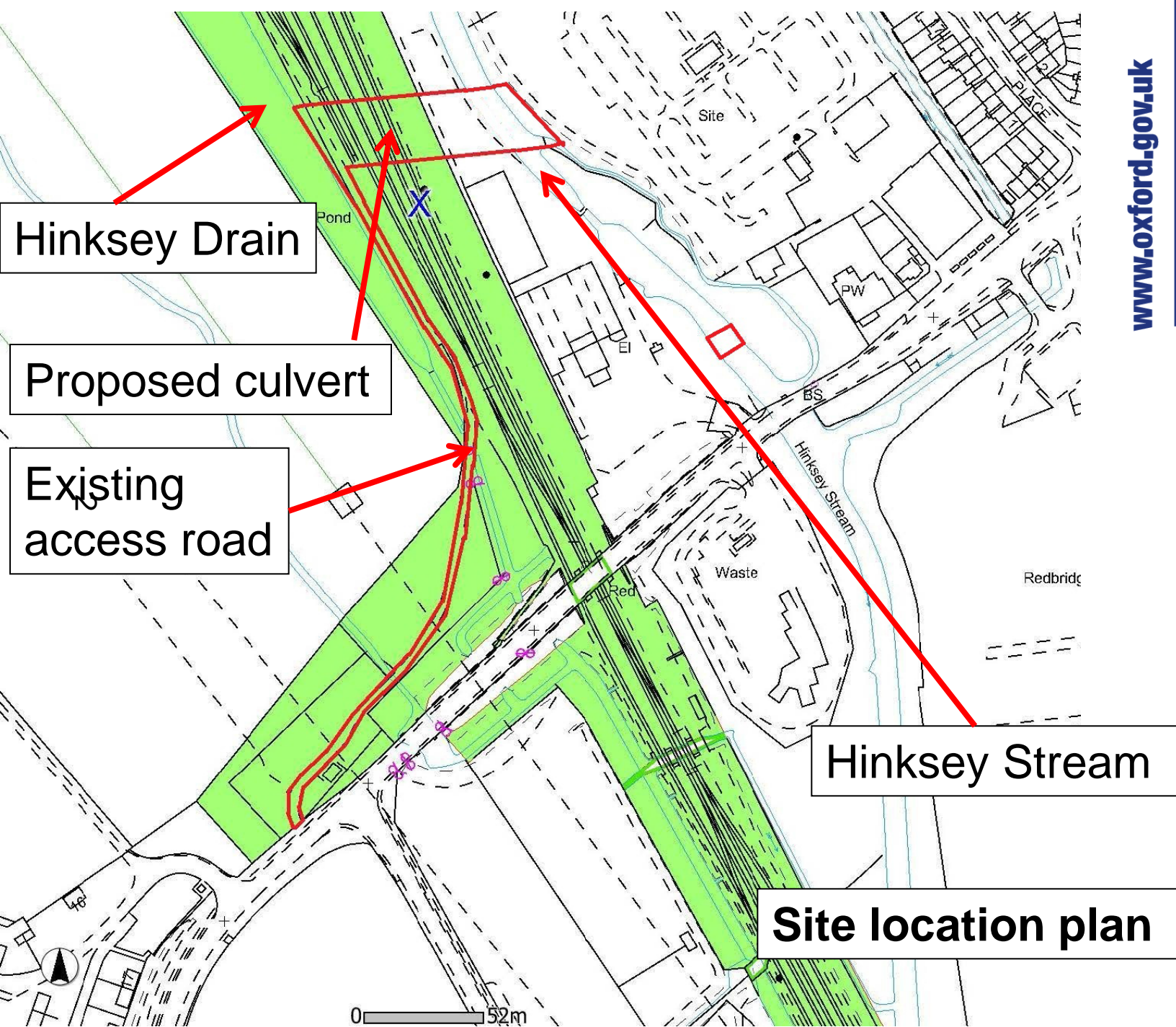



## Site location plan 2

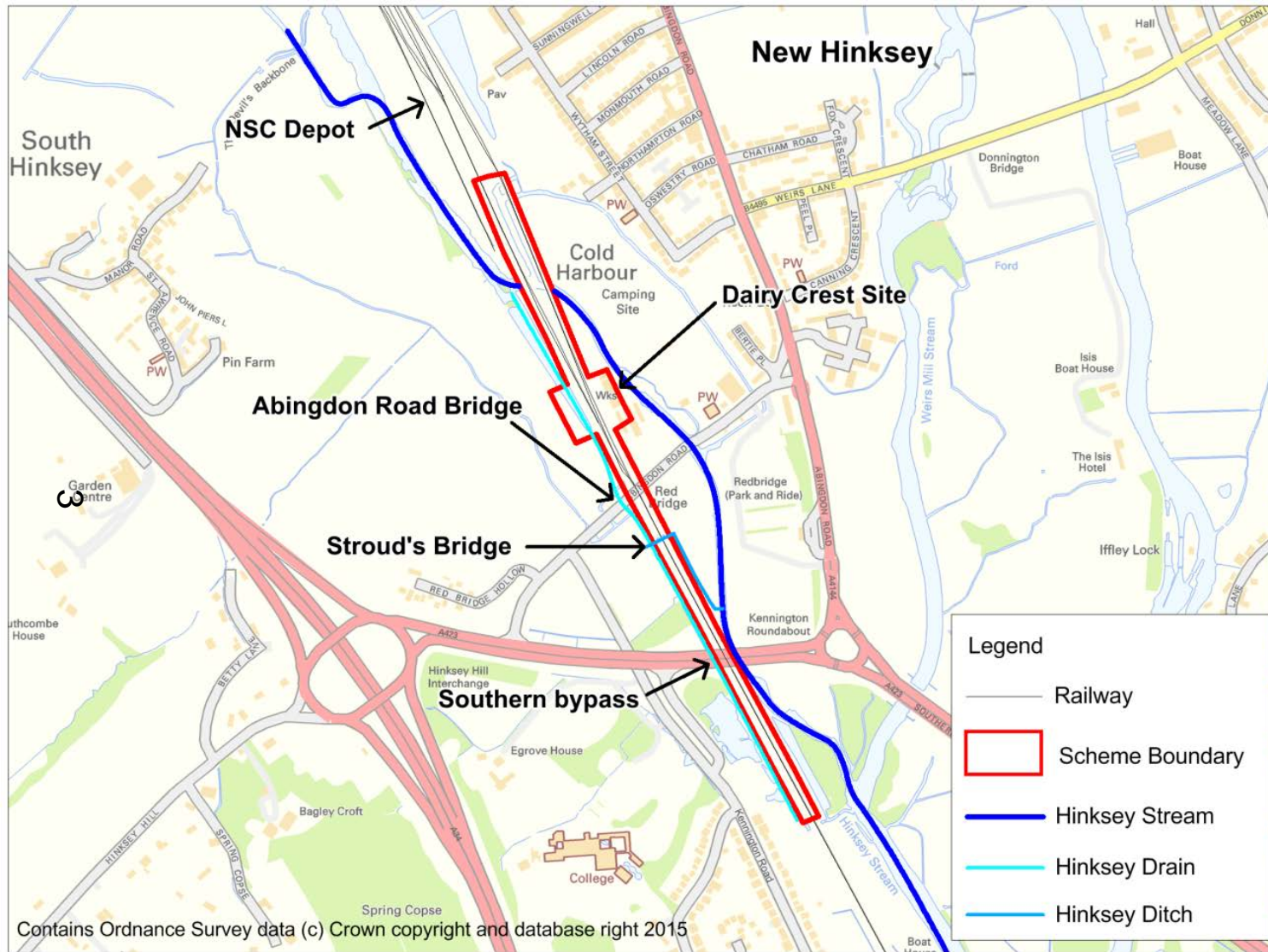

Source: Fig 2 p7 FRA





# Culvert location constraints

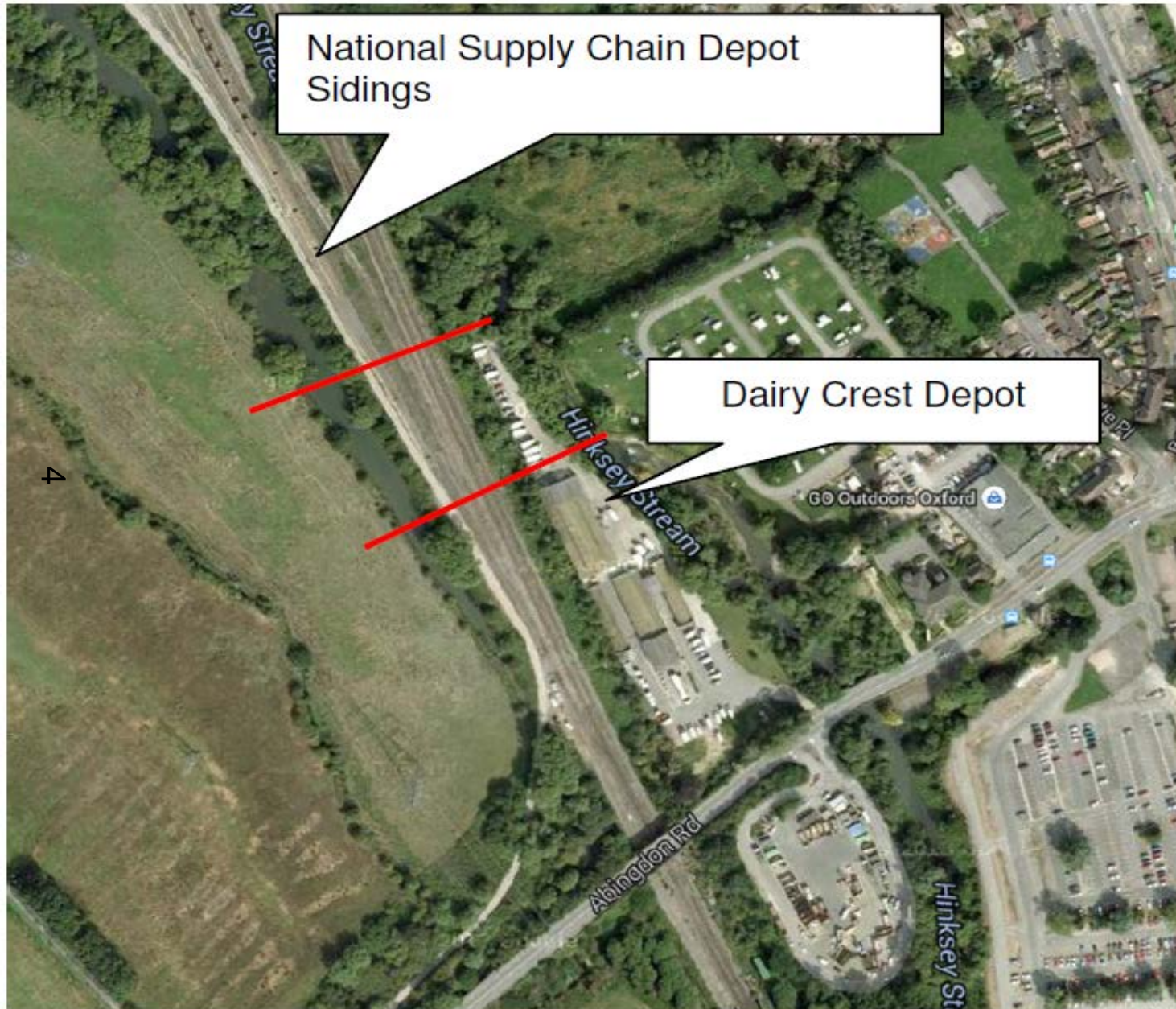

Source: Fig 4 p12 FRA



# View of site and Hinksey Stream from campsite

The site





# View of site and Hinksey Stream from campsite

The site

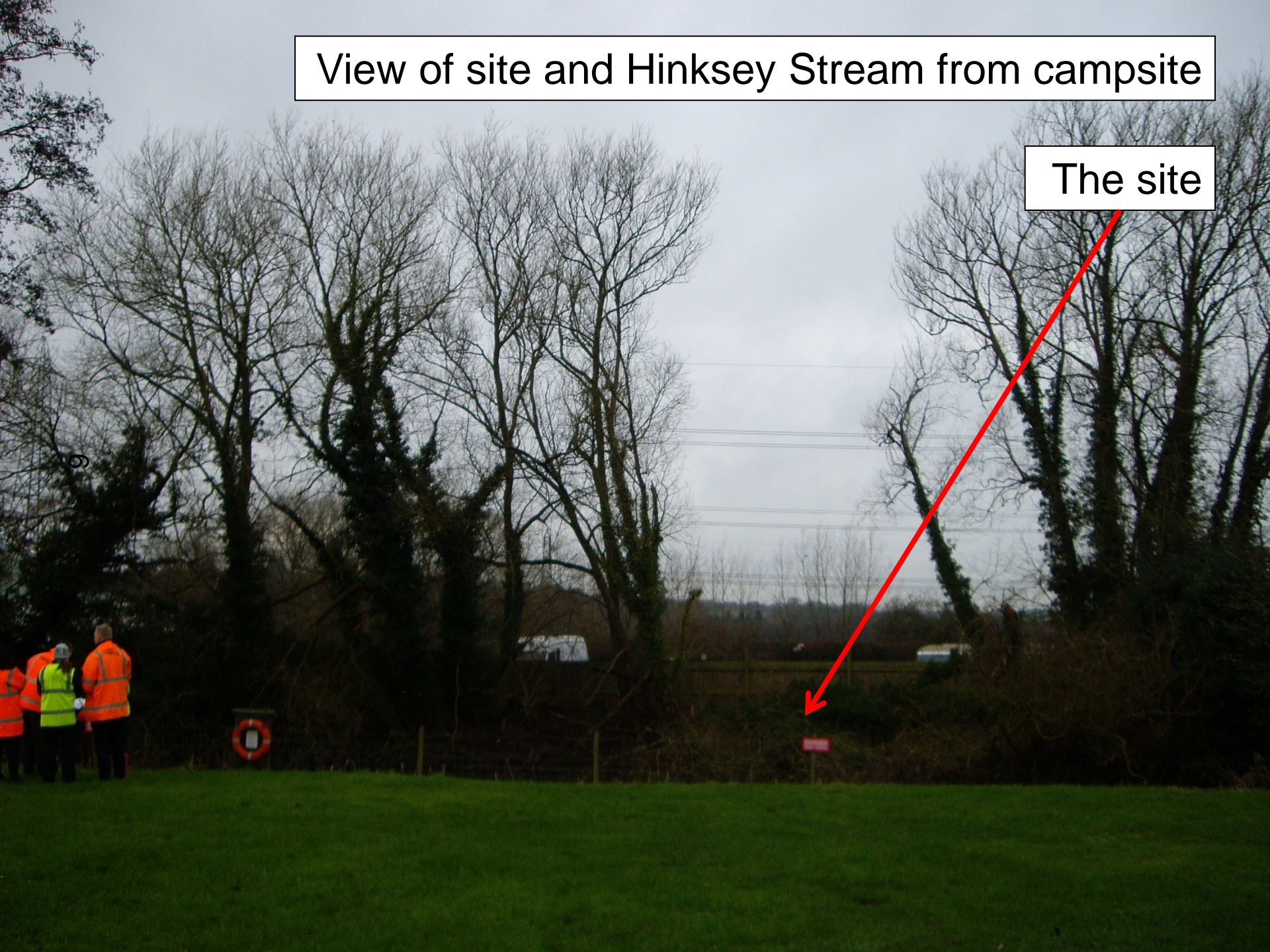



View of site and Hinksey Stream from camp site

The site





Within the Dairy Crest site

The site





The rail line in the vicinity of the site

The site





View from the site across Hinksey Drain  
towards the fields beyond

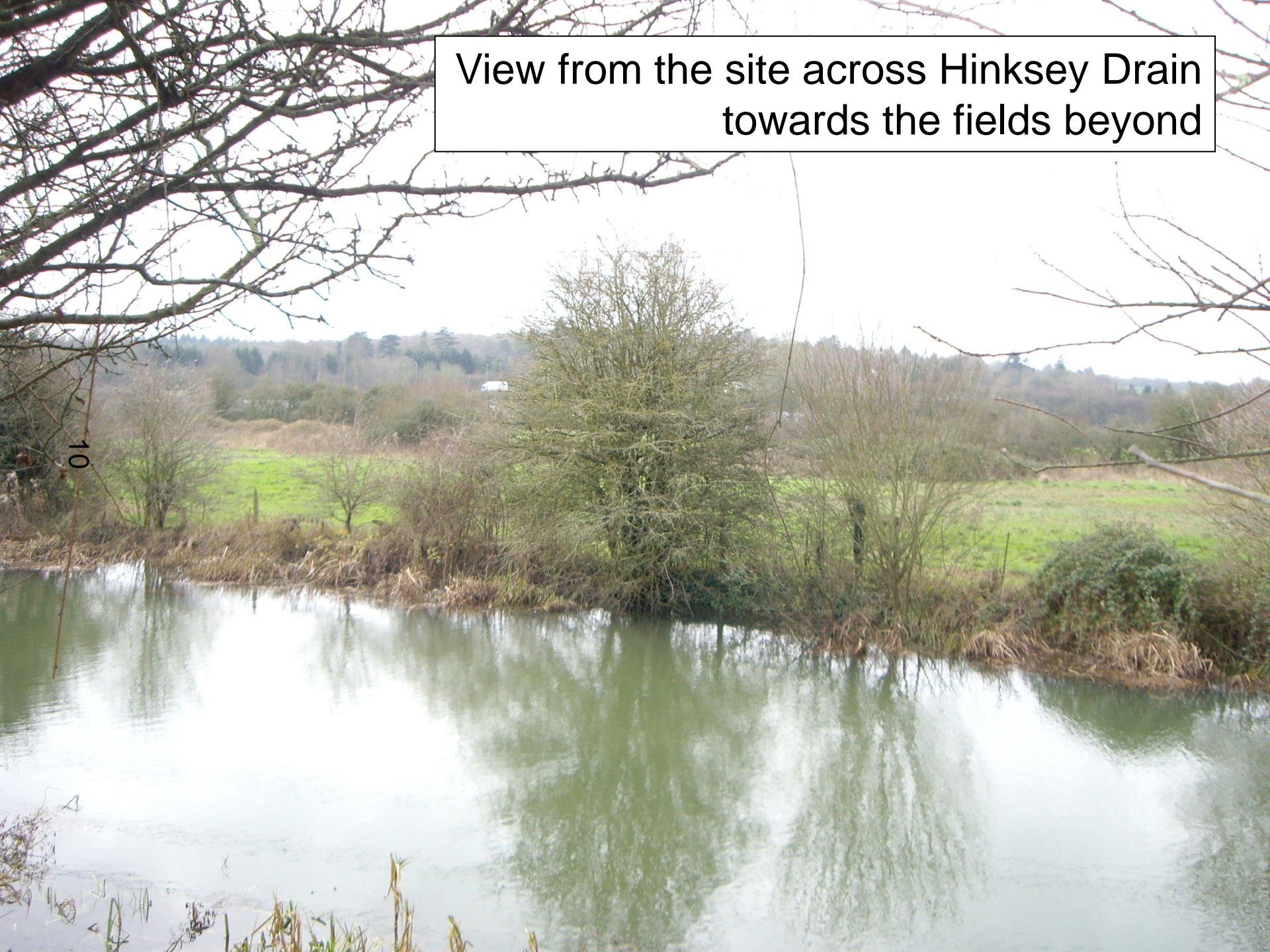



View towards the site and the fields to the west  
– site is in the hedgerow on the right

The site

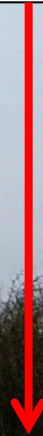

11





# Layout of proposed culvert

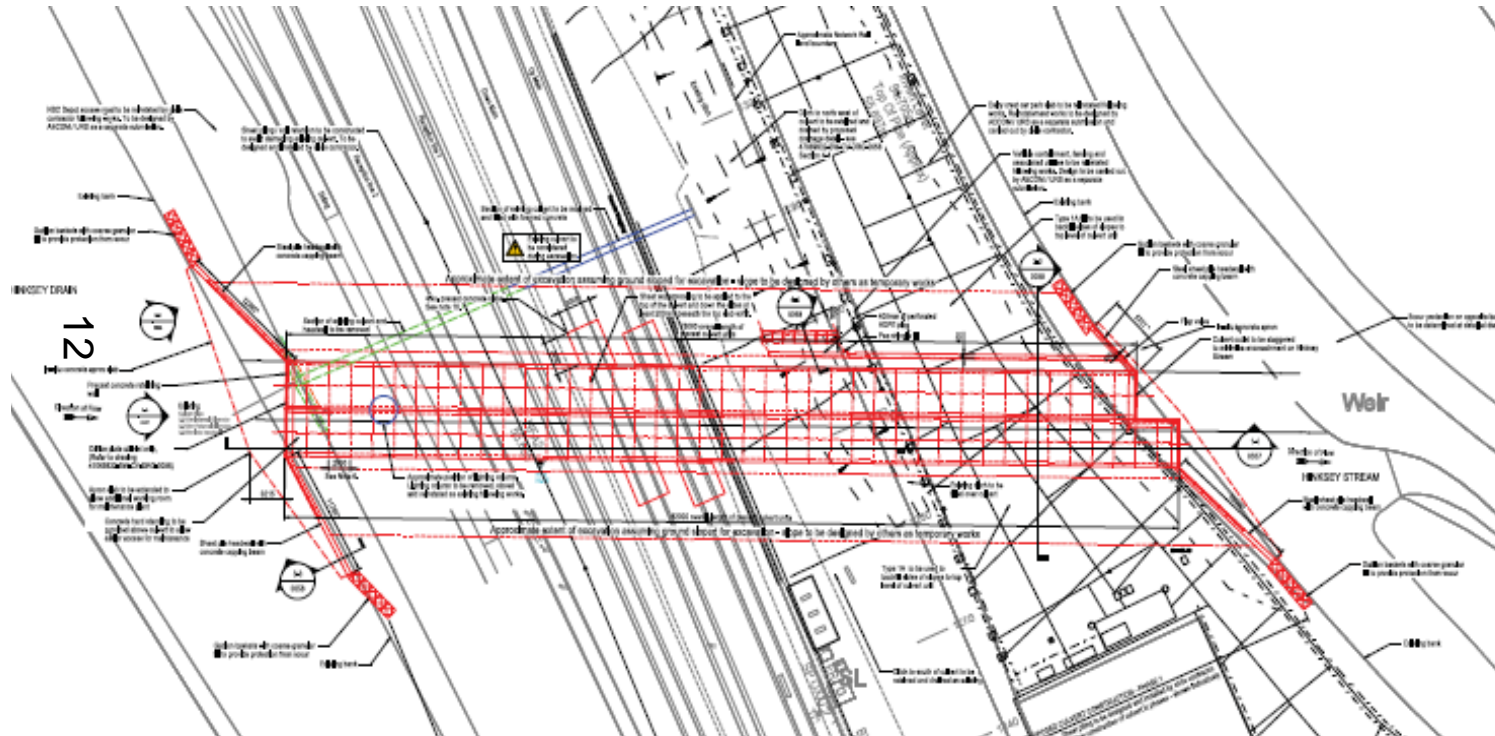



# Cross-sections

[www.oxford.gov.uk](http://www.oxford.gov.uk)

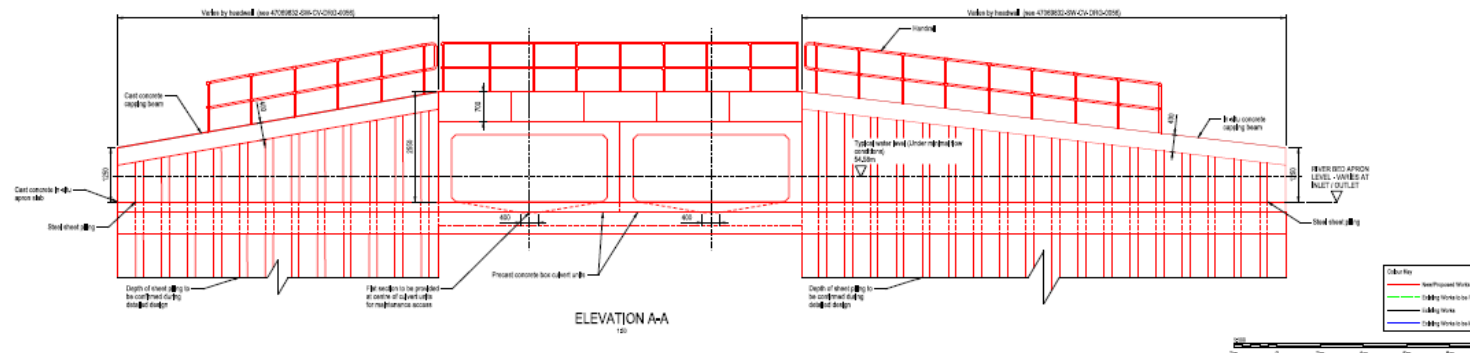
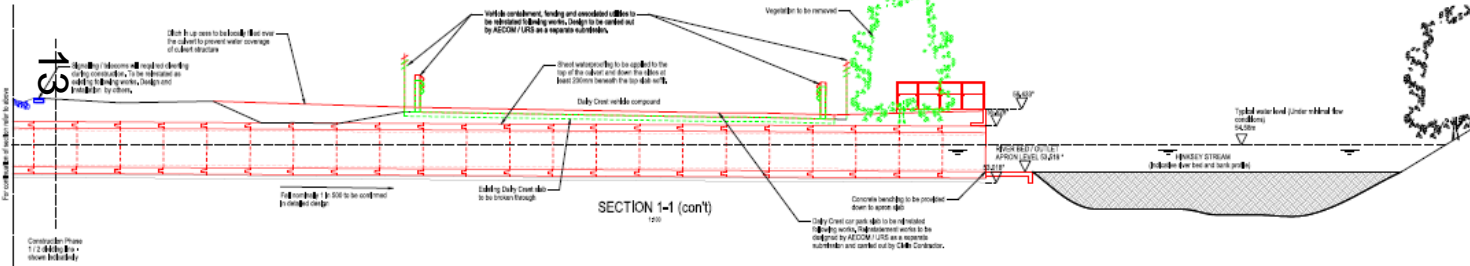
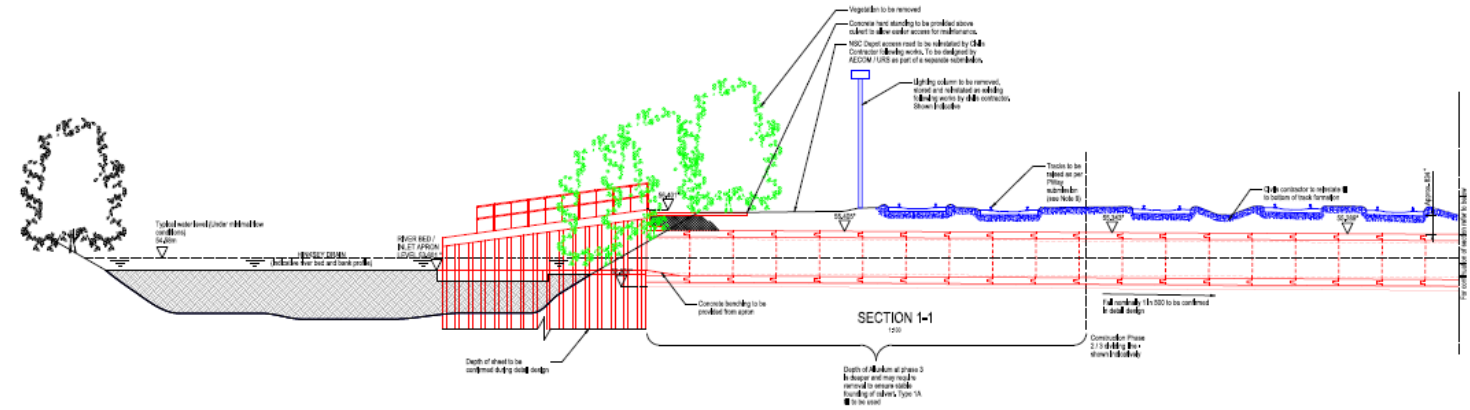



# Cross-section with orifice plate

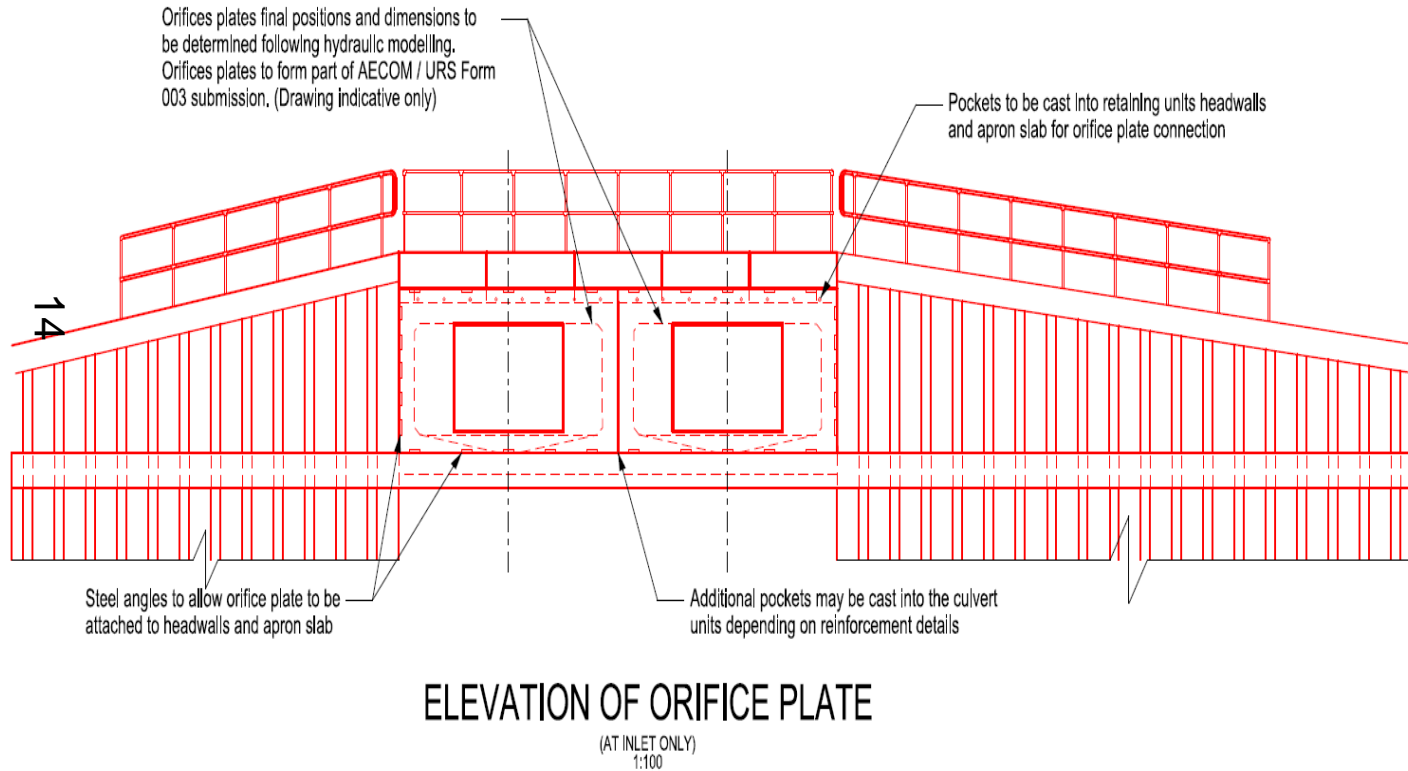



# FLOOD RISK ASSESSMENT SUMMARY

Internal Flood depth in properties before and after the proposed works

Each row is one property – 21 properties shown

Table provided by Environment Agency

using data taken from Network Rail's Level 3 Flood Risk Assessment dated March 2016

Location	Flood Depth (m) in the Property - Baseline (existing) Condition					Flood Depth (m) in the Property - Proposed Condition				
	5	20	75	100	100+cc	5	20	75	100	100+cc
East of the proposed works (Within the area where temporary defences can be deployed at Vicarage Road)	0.20	0.52	0.63	0.65	0.78	0.22	0.52	0.64	0.65	0.78
	0.06	0.38	0.49	0.51	0.64	0.08	0.38	0.50	0.51	0.64
	-	-	0.03	0.05	0.17	-	-	0.03	0.06	0.17
	-	0.04	0.15	0.16	0.31	-	0.04	0.15	0.19	0.31
	-	-	0.08	0.1	0.22	-	-	0.08	0.11	0.22
	-	-	0.09	0.11	0.23	-	-	0.09	0.12	0.23
	-	0.08	0.18	0.19	0.33	-	0.08	0.18	0.21	0.33
	-	0.1	0.2	0.21	0.36	-	0.1	0.2	0.24	0.36
	-	0.07	0.17	0.19	0.31	-	0.07	0.17	0.2	0.31
West of the proposed works (Within the area where temporary defences can be deployed at South Hinksey)	0.2	0.45	0.57	0.58	0.69	0.17	0.45	0.57	0.59	0.71
	0.04	0.29	0.41	0.42	0.53	0.01	0.29	0.41	0.43	0.55
	0.22	0.47	0.59	0.6	0.71	0.19	0.47	0.59	0.61	0.73
	0.24	0.49	0.61	0.62	0.73	0.21	0.49	0.61	0.63	0.75
	0.13	0.38	0.5	0.51	0.62	0.1	0.38	0.5	0.52	0.64
	0.19	0.44	0.56	0.57	0.68	0.16	0.44	0.56	0.58	0.7
	0.11	0.36	0.48	0.49	0.6	0.08	0.36	0.48	0.5	0.62
	0.14	0.39	0.51	0.52	0.63	0.11	0.39	0.51	0.53	0.65
	-	0.17	0.29	0.3	0.41	-	0.17	0.29	0.31	0.43
	-	0.47	0.59	0.6	0.71	-	0.47	0.59	0.61	0.73
	-	0.23	0.35	0.36	0.47	-	0.23	0.35	0.37	0.49
	-	0.19	0.3	0.32	0.43	-	0.18	0.3	0.33	0.45

	Small decrease in levels (1 to 3cm)		No change in level		Small increase in levels (1 to 3cm)
--	-------------------------------------	--	--------------------	--	-------------------------------------



Properties with existing property level flood protection

www.oxford.gov.uk





This page is intentionally left blank